

For Immediate Release

## DMM Kariyushi Aquarium Unveils Seasonal Limited Performance in Jellyfish Area

Japan (November 30<sup>th</sup>, 2020) – Starting from Tuesday, December 1<sup>st</sup>, DMM Kariyushi Aquarium will present a new seasonal light-and-sound performance in the jellyfish area.



With the changing of seasons, DMM Kariyushi Aquarium is giving the jellyfish area a makeover for a limited time. Featuring Christmas, new year and spring, the new performance comprises three major themes, showcasing the glorious champagne winter, silent falling snow in the ocean and; budding and blooming Okinawan cherry blossom in Nago city. In the illuminated water world, sounds react with the moving lights as well as the changes in colors to depict a splendid world. Specially designed lights, sounds along with the drifting jellyfish, all of these serves to create a special moment for our guests.

### Performance Details

Period : Tuesday, December 1<sup>st</sup>, 2020 to Sunday, February 28<sup>th</sup>, 2021

Venue : Jellyfish area (1<sup>st</sup> floor)

Time<sup>1</sup> : 10:00 am – 9:00 pm

Fee<sup>2</sup> : Free

Note:

<sup>1</sup>Last admission is 1 hour before closing.

<sup>2</sup>Admission ticket is required to enter the aquarium separately.

<sup>3</sup>The new performance will replace the regular performance during above period.

<sup>4</sup>Photos shown in this press release represent an artist's impression. Performance and related contents are subject to change or closure without prior notice.

<sup>5</sup>For detailed information such as tickets and opening hours of the aquarium, please refer to our official website (<https://kariyushi-aquarium.com/en/>).

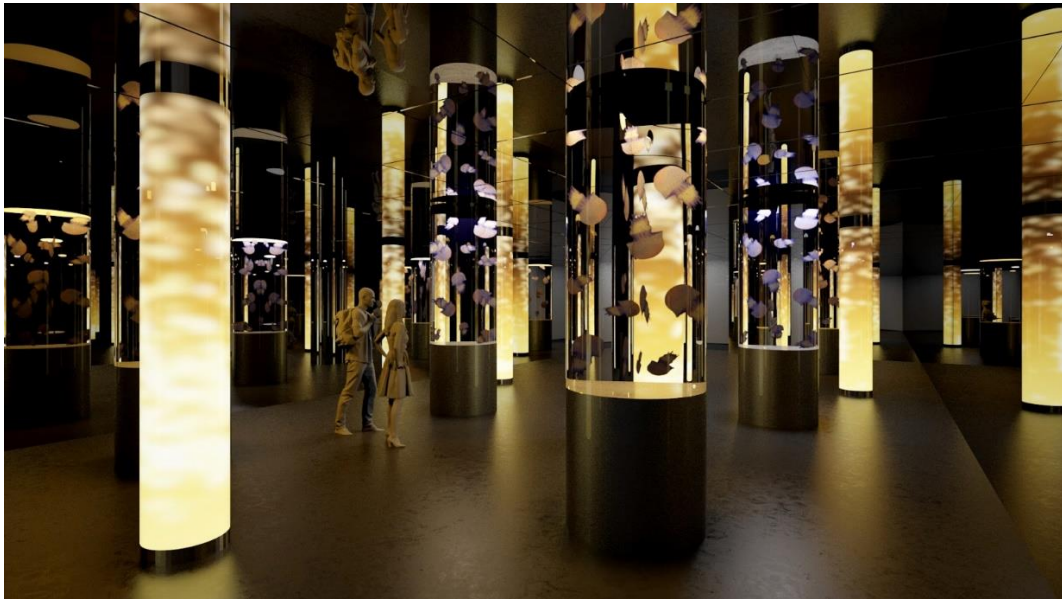

▲Glorious Champagne Winter (Artist's Impression)

### **Glorious Champagne Winter (Christmas)**

Some warm orange light particles are adding on the snowy white lights, then a champagne gold color fills the whole space to create a bright world. These flickering light particles bathe the area in a warm glow, symbolising the celebration of Christmas.

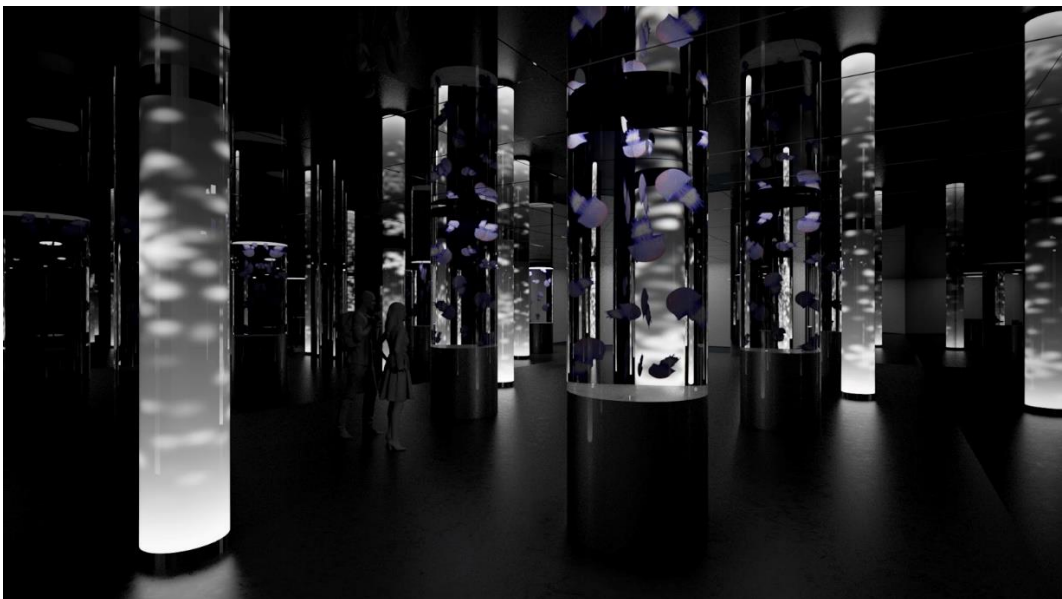

▲Silent Falling Snow in The Ocean (Artist's Impression)

### **Silent Falling Snow in The Ocean (New Year)**

Depicted by lights, snow falls from the sky silently, while sounds changes along with the twinkling lights. With increasing white lights, snow gradually transforms the dark space into a snowy world.

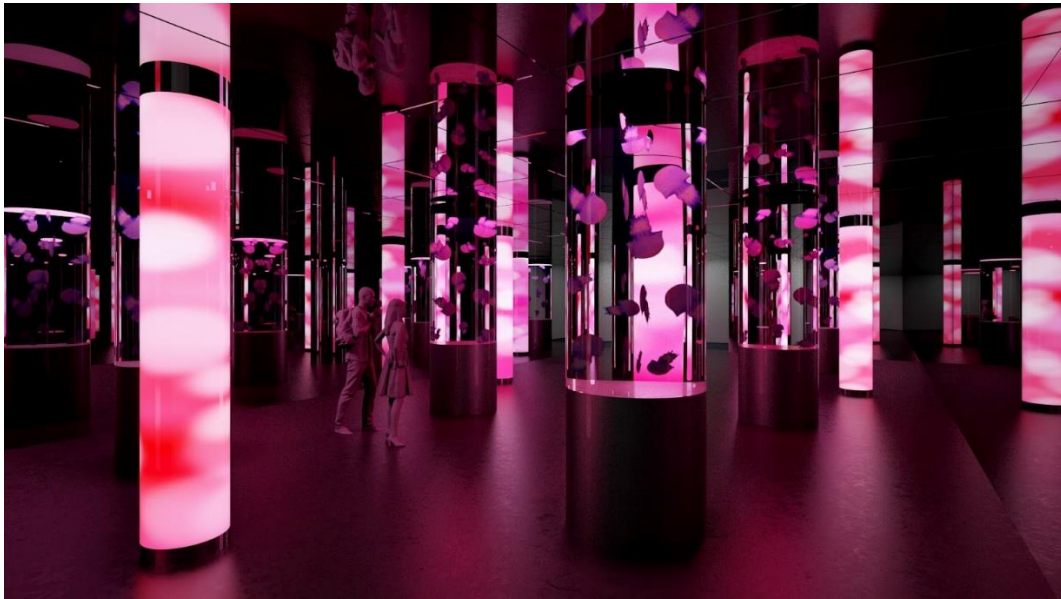

▲Budding and Blooming Okinawan Cherry Blossom  
in Nago City (Artist's Impression)

### **Budding and Blooming Okinawan Cherry Blossom in Nago City (Spring)**

Shining cylindrical pillars represent blooming cherry blossoms and turn the area into a pink color. Complemented by the gradation of pink color signifying the wind of spring. The whole composition symbolises the fully bloomed Okinawan cherry blossoms (Kanhizakura) in Nago city between January and February. Then lights start sparkling which indicates scattering cherry blossoms and brings the performance to an end.

#####

### **For Media Related Inquiry**

Contact : Josephine Kwan  
Email : [aquarium-info@dmm.com](mailto:aquarium-info@dmm.com)  
Head Office : 3-59, Toyosaki, Tomigusuku-Shi, Okinawa 901-0225, Japan  
Tokyo Office : Sumitomo Fudosan Roppongi Grand Tower 24F  
3-2-1, Roppongi, Minato-Ku, Tokyo 106-6224, Japan  
(Marketing Department)

▼DMM Kariyushi Aquarium  
<https://kariyushi-aquarium.com/en/>

▼DMM Kariyushi Aquarium Official SNS (Japanese)  
Facebook : <https://www.facebook.com/dmm.kariyushi.aquarium/>  
Instagram : [https://www.instagram.com/dmm\\_aquarium/](https://www.instagram.com/dmm_aquarium/)  
Twitter : [https://twitter.com/dmm\\_kariyushi](https://twitter.com/dmm_kariyushi)  
YouTube : <https://www.youtube.com/DMMかりゆし水族館>

▼DMM RESORTS Co., Ltd.

<https://dmm-resorts.co.jp/en/>

## **Note to Editors:**

### **About DMM Kariyushi Aquarium**

DMM Kariyushi Aquarium is opened on Monday, May 25<sup>th</sup>, 2020. It is located in the shopping mall (ias Okinawa Toyosaki) in Toyosaki, Tomigusuku-shi, Okinawa Prefecture. The Aquarium is approximately a 20 minutes drive\* from Naha Airport.

DMM Kariyushi Aquarium bears the theme of a “new entertainment aquarium”, which combines the latest visual expression and spatial representation. The beauty of nature displayed, including fauna & flora native to the Okinawa region, allows visitors to forget their physical presence in a commercial facility.

\*The distance from the airport is approximately 5km, and the commute varies depending on the traffic.